



JPY SOLUTIONS SYSTEM CO. LTD.

***“CREATING VALUABLE SPACE”***



# CONTENTS

COMPANY OVERVIEW	3
WHAT WE DO	4
PRODUCTS INTRODUCTION	5
CONTACT INFORMATION	22

## OVERVIEW

JPY Solutions Systems Co. Ltd. is a storage racking system partner that is dedicated to consistently providing high customer satisfaction by rendering good quality products, excellent service and after sales services at an acceptable price/value relationship

With the fast growing of every business in the country right now, a need of storage is inevitable, and this promising trend is an opportunity for JPY Solutions System Co. Ltd. to help you with your storage racking system. Regardless if you're a small, medium, multinational or international company, as long as you need a full service storage racking system, you can count on JPY Solutions System.

### Our Mission

To supply racking system and its services that help our client utilize their storage taking consideration its safety and efficiency.



### Our Vision

To be the one of the most reliable storage provider in the industry.

### Reputation

The owner and its people gained their knowledge and experienced for working in the storage racking system industry for many years

## WHAT WE DO?

### SUPPLY

Supply of Heavy Duty, Medium Duty, and Light Duty Storage racks and its Accessories.

### SERVICES

Installation, Dismantling and Assessment of Racks Products





# PRODUCT INTRODUCTION

## Pallet Racking System

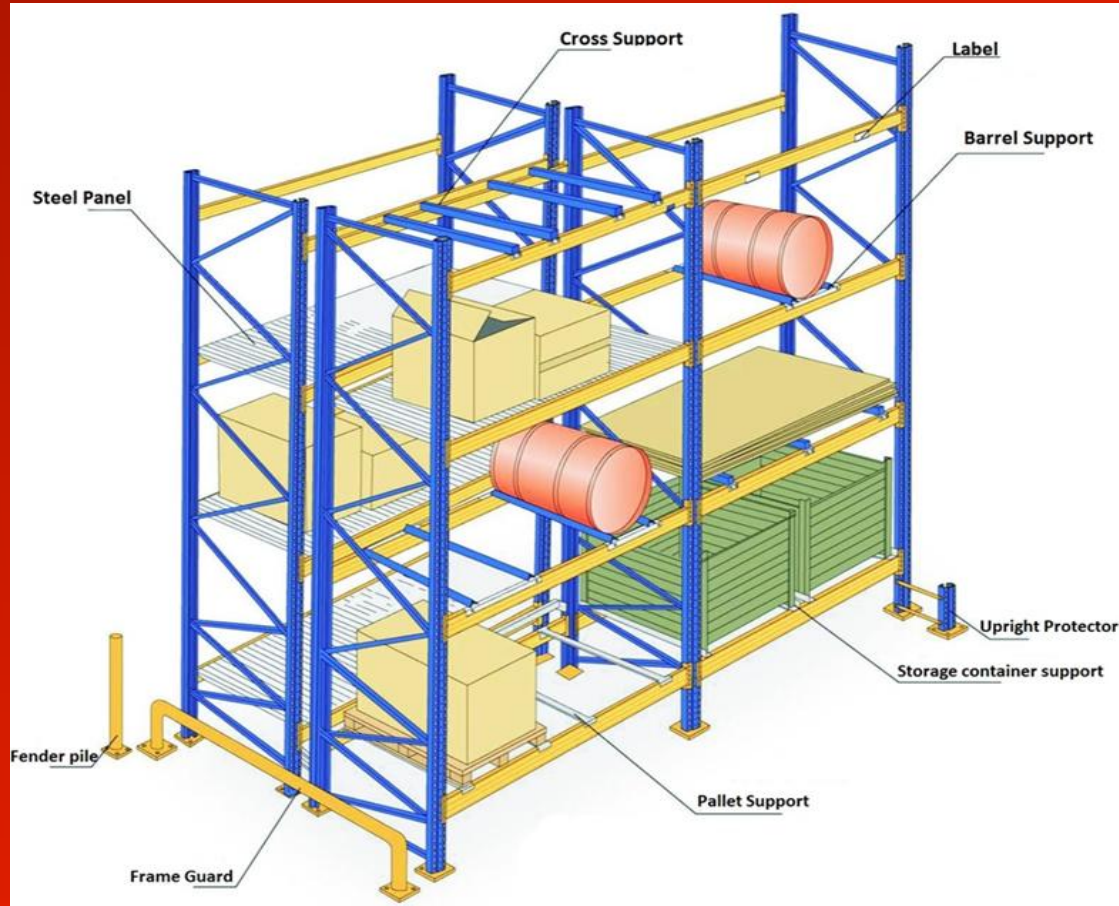

# SELECTIVE PALLET RACKING SYSTEM

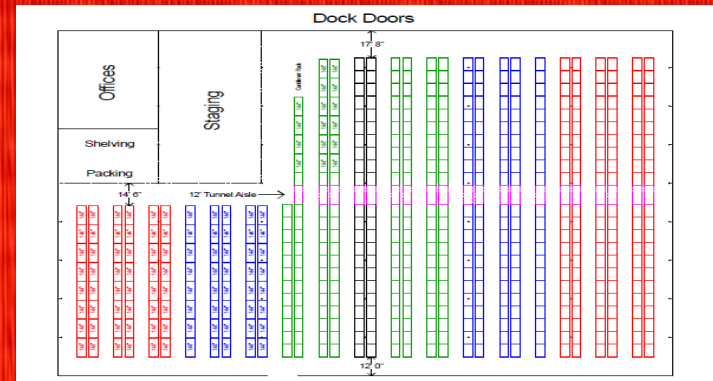

Pallet racking can be adjustable and suitable for the forklift working. There are two kinds of aisle that can be chosen: one is a normal aisle about 3000mm; another aisle about 1700mm which requires special forklift to fetch.

- FIFO principle (Optimum stock control)
- Flexibility at the height and depth of the loads.
- Can be laid out in single and double-sided runs.
- Storage ability of different types of load with different load heights.



# DRIVE IN RACKING SYSTEM

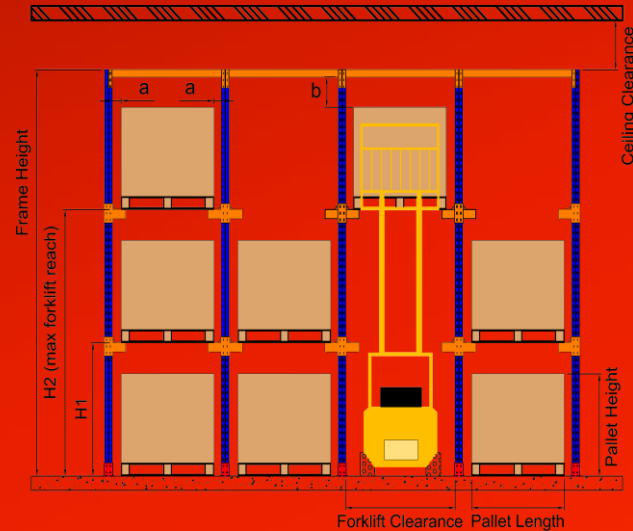

This kind of racking uses forklift to fetch goods. Space is more effectively used because the working passage for the truck and the storage space are combined together. For the character of first in - last out only one kind of goods can be stored along one working passage, or goods along one passage has to be done one at a time. It is widely used among business which goods are single species, normally use at wholesale, cold storage, tobacco and food industrial.

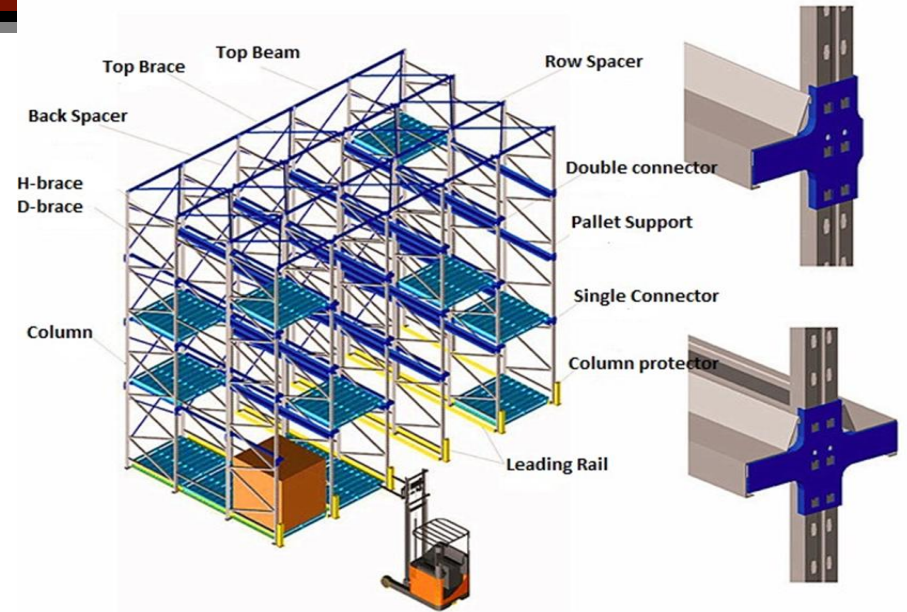



# MEZZANINE RACKING SYSTEM

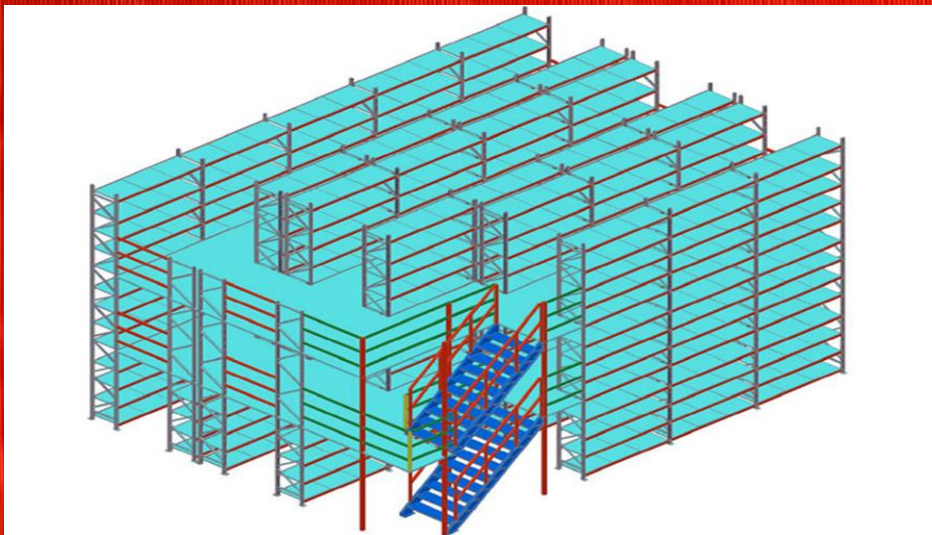
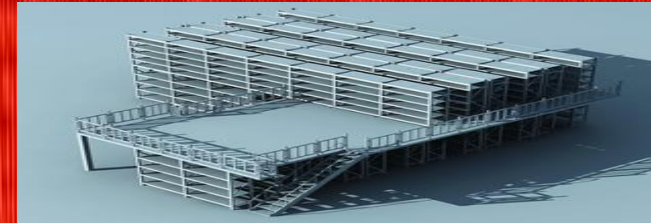



# MEZZANINE RACKING SYSTEM



Mezzanine takes the multi-tier rack structure. It can be designed into multi-floor (usually 2-3 layer), with stairs, handrails and cargo lift, etc.. Floor panel usually used cold-rolled steel floor with mutual buckle type structure. It can be equipped with lighting system. The load capacity of each level shelf is usually within 500 kg.; while the loading of floor panel is between 300-1000kgs per square meter.

## Feature:

- Mezzanine Racking is subject to manpower operation, light weight goods storage, large storage quantity goods handling in a high-clear-height warehouse.
- Mezzanine Racking enables a higher shelving system, which makes full and better use of storage height and space.
- Mezzanine Racking occupies a humanized and quality design. Easily assembled and disassembled.
- Mezzanine Racking is especially suitable for transformation of old warehouses.

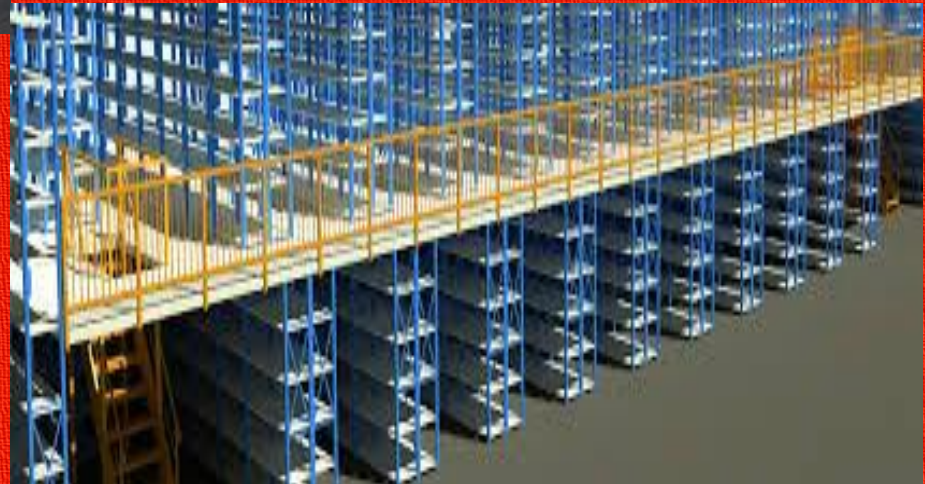



# STEEL PLATFORM SYSTEM

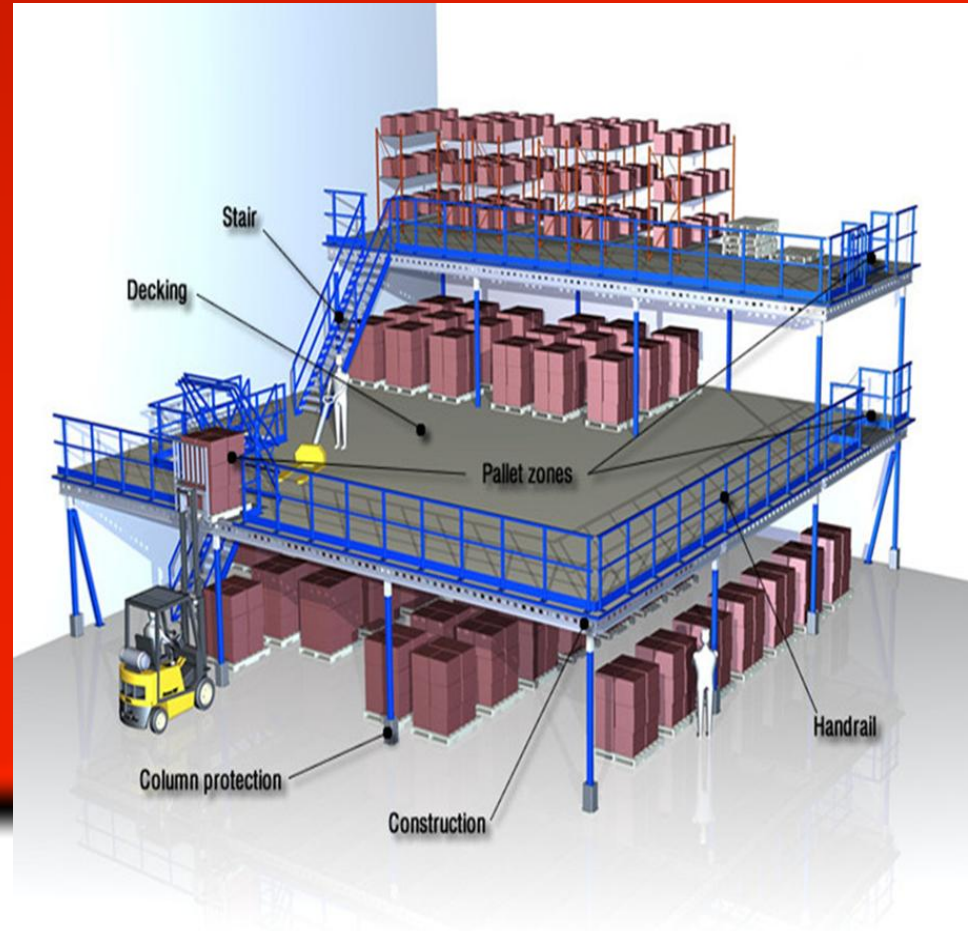

## Features:

- Make full use of warehouse space and enhance the utilization rate
- Take advantage of upper space to store goods or shelving's
- Mezzanine Floor can be customized
- Lightening devices can be set on the mezzanine floor



# SHUTTLE RACKING SYSTEM



Shuttle rack system is a system composed of high density storage racking, shuttle and forklift. This new concept storage racking system is more powerful in operation than that of traditional storage racking, which enable it to take advantage of warehouse space sufficiently. The space utilization rate of it is more than 80%.

Shuttle rack, a complete set of high density storage system, is composed of racking's, shuttles and forklift. This kind of storage system offer a new option of improving warehouse space utilization.





# LONG SPAN RACKING SYSTEM

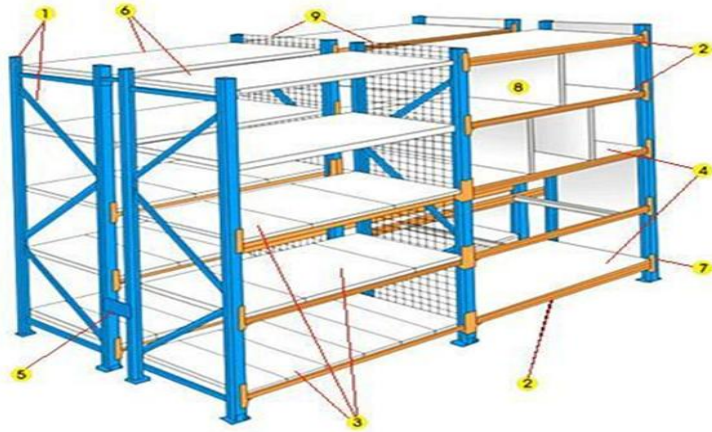

Suitable for handling by hand material – can be designed the proper size according to the material storage equipment.

Features:

Suitable for manual operation

Average loading for each layer: 200-800kgs

Can be adjusted by pitch of 50mm

Other accessories like back protector, wire mesh, back board, side board can be used.



# CANTILEVER RACKING SYSTEM

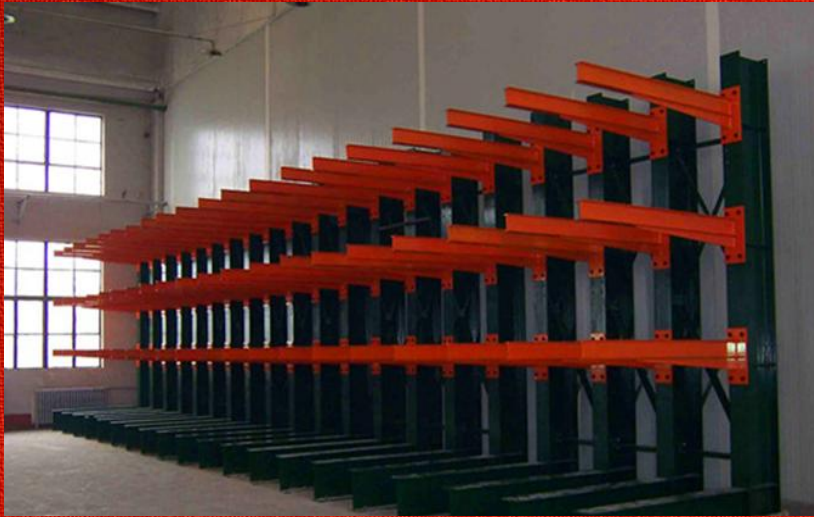

This type of racking is suitable for keeping materials of big, long size, such as pipes and shaped steel, etc. Materials are put on the cantilever. Forklift truck and stacking crane are often applied with the rack. This is suitable for small warehouse and popular with machinery processing and building – material supermarket.

Features:

- Apply to long or scroll-shaped long items storage
- Low space utilization rate, about 35-50%
- Suitable for building material production plant, furniture manufacturer or Supermarket
- Can be equipped with panel according to requirements





# CARTON FLOW RACKING SYSTEM



Depending on gravity, goods stored on carton flow racking can move automatically, which can realize "First In First Out" operation. It is suitable for storage of large quantity of similar goods. Both the efficiency of goods storage and picking and the space utilization rate are high.

- First In Last Out. It can achieve one time storage and several time picking
- High rate of racking utilization and suitable for large quantity goods in short-term Storage.





# STEEL SHELVINGS SYSTEM



Steel Shelf or Modular shelving is suitable for almost any hand-loaded storage requirement from single to multi-tier applications, to high bay picking. Modular is design for ease of assembly. It offers almost limitless scope for the creation of customized storage facility and a complementary range of accessories extends its capabilities still further. It is an ideal storage solution to auto parts warehouse and logistics operations in the automotive, pharmaceutical and electronics industries.

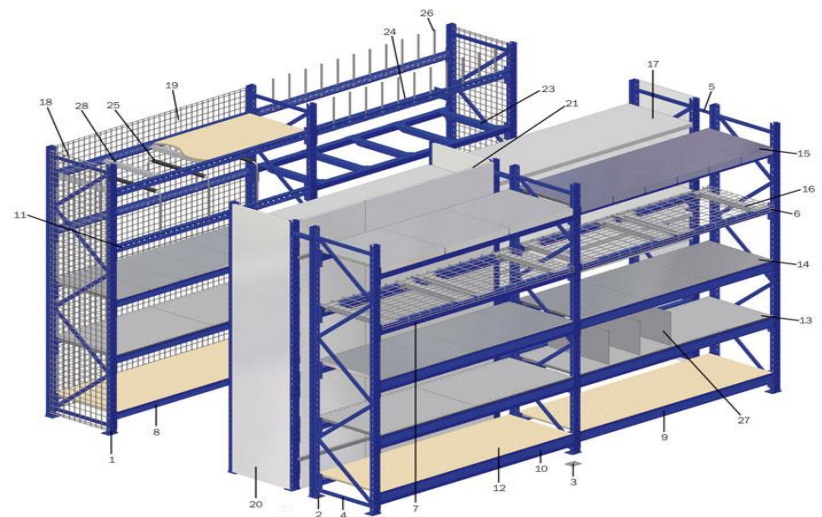

# MOLD STORAGE SYSTEM



Mold Storage Rack is mainly used for storage of all kinds of mold such as plastic mold, metal molds, casting mold, powder metallurgy mold and extrusion die.

Features:

- Safe and reliable: additional positioning devices to make use of it safe and reliable
- Convenient operation: Sliding and moving by bearings, equipped with electric block and no need of bridge crane and forklift.





# SLOTTED SHELVINGS SYSTEM



Slotted angle shelving has the advantages of low costs, safety and reliability, convenient assembly and dis-assembly and free adjustment etc.

The top and bottom panel of slotted angle shelving are connected with posts by triangle plate, bolts and nuts, which make the shelving stable. The middle-level panels are connected with posts by 8 pcs of clips each level. It is convenient to assemble and disassemble. The steel panel can be adjusted in height by 50mm pitch, which can meet various needs.





# SUPERMARKET SHELVINGS



Supermarket Rack, also called retail display racking, is designed for supermarket.

Features:

- Beautiful in external feature; firm in structure and various in specification
- Large load capacity; Suitable for all kinds of retail stores
- Powder coating with many color options; corrosion protection and rust proof
- Easily assembled and dis-assembled





# STEEL PALLET



## Features:

- The load capacity of steel pallet is the strongest in all kinds of pallets
- 100% environmental protection, can be recycled
- Water-proof, moisture-proof and anti-rust
- Comparing with plastic pallet, it is with strength, wear-resistance, heat-resistance and low costs.
- The chassis is strong, light in weight and strong in steel





# PLASTIC PALLET

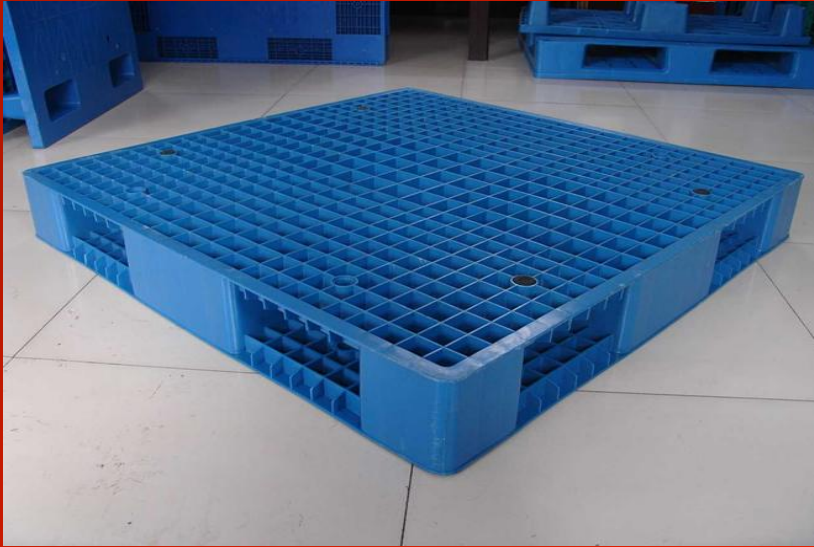

Plastic pallet is an important tool for unit material storage. Plastic pallet is with loading sides and forklift entrances. Using plastic pallets can facilitate cargo handling, transportation, storage and distribution. It is widely used in machinery, electronics, food, and automobile industries. It has the advantages of light weight, corrosion resistance, long service life and recycling, which is suitable for factories and distribution centers.



# METAL CONTAINER



Metal container, also called storage cage, was developed on the basis of steel pallets to solve the defects of steel pallet which is unavailable to hold small items or bulk materials. The base of steel container is as same as that of steel pallet which is convenient for forklift entrance. The upper side of it can not only be lifted but stacked. When storing goods, the max stacking is 4 layers, which realizes the 3-dimensional storage. According to structure, it can be divided into fixed and folded style; according to material choice, it can be divided into box and wire mesh type.







## CONTACT INFORMATION

<u>Address</u>	Room 403, 4 <sup>th</sup> Floor Ablaza Building, 117 E. Rodriguez Sr. Avenue, Quezon City Metro Manila, Philippines
<u>Telephone</u>	(632) 617 – 4975
<u>Mobile</u>	(63) 917 – 8057708 , 906 – 5153395
<u>Email</u>	jpysolutionss@gmail.com
<u>Website</u>	www.jpysolutionss.com